

Replacement Parts:

PART	AMOUNT	DESCRIPTION	ITEM NUMBER
①	3	27" Elbow Tubes	2778Z1
②	3	27" Elbow Tubes	2778Z2
③	2	31" Straight Tubes	2778Z3
④	2	31" Straight Tubes	2778Z4
⑤	2	39" Elbow Tubes	2778Z5
⑥	2	Adjustable Tubes	2778Z11
⑦	2	3.5" Straight Tubes	2778Z12
⑧	4	2 3/8" Butterfly Screws	2778Z13
⑨	2	3" Butterfly Screws	2778Z14
⑩	24	Bungees	2778Z15
⑪	1	Net	2778Z6
⑫	1	Target Ribbon	2778Z7
⑬	4	Ground Stakes	

Step 1:
Make three "U" shapes by placing **Part (1)** into **Part (2)** and snapping push pins into place.



Step 2:
Make two net frame sides by placing **Part (3)** into **Part (4)** and snapping push pins into place.



Step 3:

To make the frame for the net, use one of the assembled "U" shaped tubes from Step 1 and place an assembled straight tube from Step 2 into the open end. Take the second straight tube and place into the other open end. Make sure all push pins are engaged. You should now have a rectangle shape.

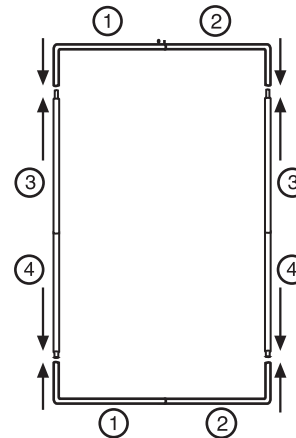

Step 4:

To make the base assembly, use the third "U" shaped tube from Step 1 and place **Part (5)** into one of the open ends. Repeat on other side. Slide 4 ground stakes **Part (13)** on assembly positioned as shown. Next, add side supports. Attach **Part (7)** to base on outside of "U" shape tubing where the pre-drilled holes are. Attach with bolt and wing nut (**Part 8**). Repeat on other side.

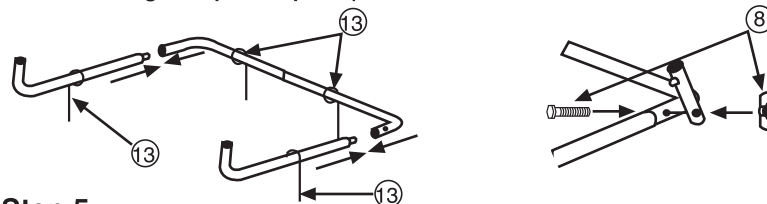

Step 5:

To attach net frame to base assembly, place the net frame between the open ends of the base assembly making sure to line up the pre-drilled holes on the net frame. Attach bolt and wing nut **Part (9)** on both sides. Next, attach both pieces of **Part (6)** to the top outside of the net frame where pre-drilled holes are using bolts and wing nuts **Part (8)**.

