

**Franklin®**

**FUTURE  
\*\*\*CHAMPS®**

# BACKYARD FOOT GOLF

ITEM NUMBER: **60192** **60192T30**

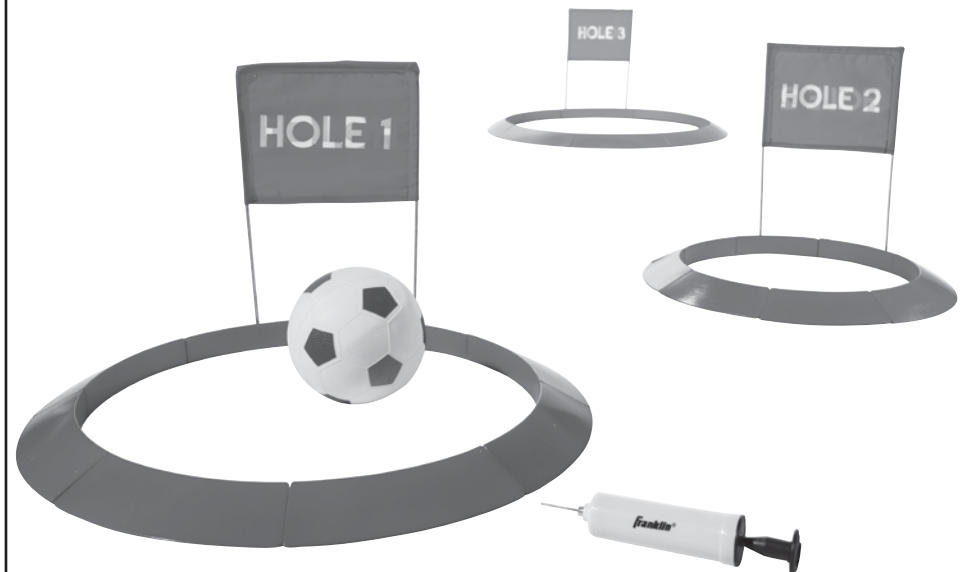

**WARNING:**  
CHOKING HAZARD--Small parts.  
Not for children under 3 yrs.

**NOTE: PRINT FRONT TO BACK**

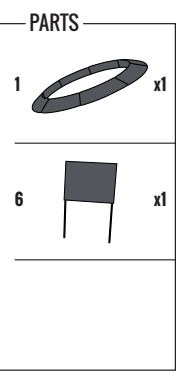
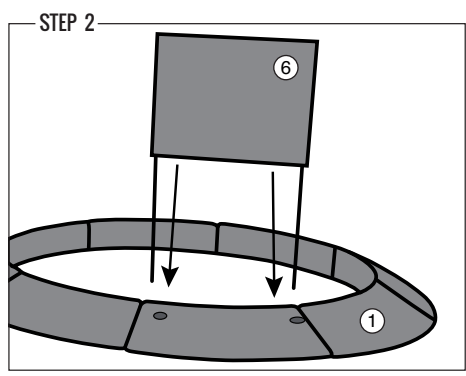

**NOTE**

Each target has 1 piece containing 2 holes for the flags. Take each **Flag** (#6) and insert into the holes of each target as shown. If playing outdoors, these can be pushed through the target and into the ground to act as ground stakes so the targets don't move around.

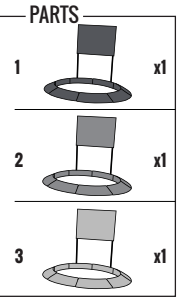
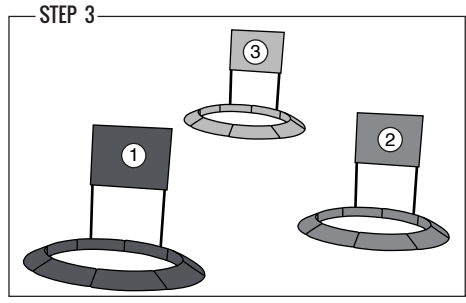

**NOTE**

Place the targets on the ground in their desired locations.

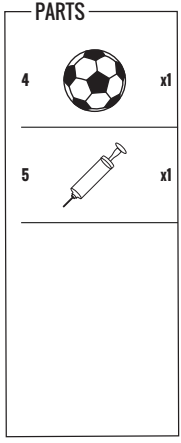
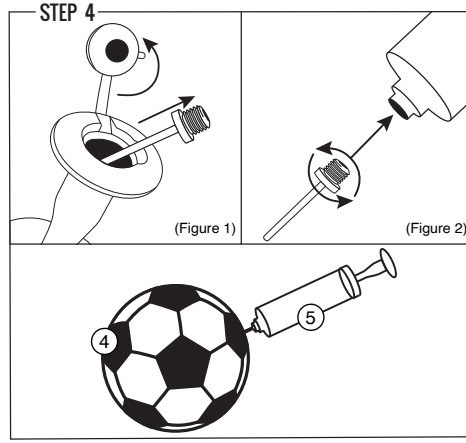

**NOTE**

Inflate your **Soccer Ball** (#4) using the **Inflation Pump with Needle** (#5) that's included. To find the needle in the pump, simply open the top cap as shown, take the needle out of this compartment (Figure 1), and screw into the bottom of the pump (Figure 2).

## YOU ARE NOW READY TO PLAY!

**GAME RULES**

Mark your "starting" location and begin by shooting on HOLE 1. See how many shots it takes you to sink the hole! Once finished, the next player gets a turn to go after the same hole by starting at the same "starting" location. Keep playing until you've played out every hole. Then move the holes around and play for another 3 rounds! Keep track of your score after each round. The lowest score at the end of the game wins!

Made In China  
Franklin Sports Inc.  
Stoughton, MA 02072



For replacement parts:  
Visit: [franklinsports.com/instructions](http://franklinsports.com/instructions)  
Email: [parts@franklinsports.com](mailto:parts@franklinsports.com)  
Call: 1-800-225-8649



## CUSTOMER SERVICE COMMITMENT

Thank you for purchasing this Franklin® product! In the event that the product you've purchased has missing or damaged parts, please contact us at:

[parts@franklinsports.com](mailto:parts@franklinsports.com)

or

Visit our website at: [franklinsports.com/instructions](http://franklinsports.com/instructions)

If possible, please include product part number and parts description so we can best assist you.



# WE'RE HERE FOR YOU!

**PLEASE DO NOT RETURN THIS PRODUCT TO THE STORE IT WAS PURCHASED FROM.**

**WE ARE COMMITTED TO FULFILLING ALL REPLACEMENT PART NEEDS IMMEDIATELY.**

Thank you for your continued support, and welcome to the #FranklinFamily!

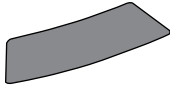
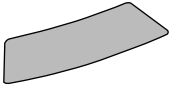
## PARTS LIST

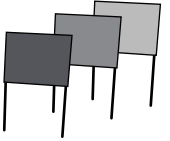
1		2		3	
	QTY <b>x6</b>		QTY <b>x6</b>		QTY <b>x6</b>
Red Target Pieces		Blue Target Pieces		Green Target Pieces	
Rep. Part: 60192-R1		Rep. Part: 60192-R2		Rep. Part: 60192-R3	
4		5		6	
	QTY <b>x1</b>		QTY <b>x1</b>		QTY <b>x3</b>
Soccer Ball		Inflation Pump and Needle		Hole Flags	
Rep. Part: 60222		Rep. Part: 60221		Rep. Part: 60192-R4	

## ASSEMBLY INSTRUCTIONS

### GENERAL NOTE

Remove the product from the box and make sure all parts from the parts list are included. Find a clean, level place to begin the assembly of your FOOT GOLF.

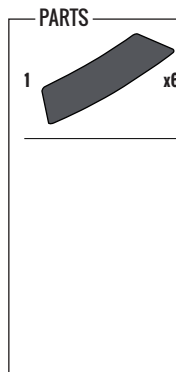
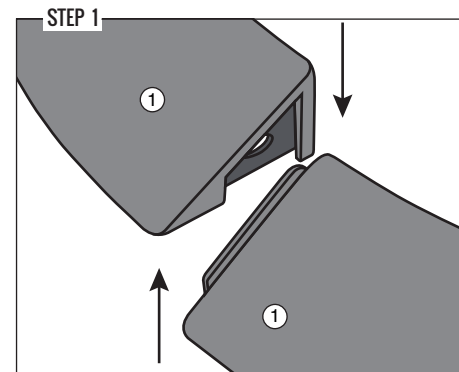

**NOTE**  
Start with the **Red Target Pieces (#1)**. Slide and lock each target piece in place as shown in the illustration. Continue sliding and locking each piece in place until the full circle target is assembled. Repeat this process for each color.