

**MULTI PLAYER:**

Set a boundary line for you and your opponent to shoot from. Turn on the target and divide the colored bean bags between teams. Stand about 4 feet (1.22m) from each other, and shoot when the bean bag target moves toward you! The first player to 21 points wins!

If you're playing with teams, then each player on a team gets 3 shots before passing to the next.

**YOU ARE NOW READY TO PLAY!**

Made In China  
Franklin Sports Inc.  
Stoughton, MA 02072



For replacement parts:  
Visit: [www.franklinsports.com/60273](http://www.franklinsports.com/60273)  
Email: [parts@franklinsports.com](mailto:parts@franklinsports.com)  
Call: 1-800-225-8649

Ages 3+



**RUNAWAY  
BEAN BAG TOSS**

ITEM NUMBER: **60273**

For all your replacement part needs, please visit:  
[www.franklinsports.com/60273](http://www.franklinsports.com/60273)



**CAUTION:**

Not for use by children without adult supervision.  
Play in a clear area. Caution should be taken when  
in use.

**NOTE: PRINT FRONT TO BACK**

# Franklin®

## CUSTOMER SERVICE COMMITMENT

Thank you for purchasing this Franklin® product! In the event that the product you've purchased has missing or damaged parts, please contact us at:

[parts@franklinsports.com](mailto:parts@franklinsports.com)

or

Visit our website at: [www.franklinsports.com/60273](http://www.franklinsports.com/60273)

If possible, please include product part number and parts description so we can best assist you.

## WE'RE HERE FOR YOU!

**PLEASE DO NOT RETURN THIS PRODUCT TO THE STORE IT WAS PURCHASED FROM.**

**WE ARE COMMITTED TO FULFILLING ALL REPLACEMENT PART NEEDS IMMEDIATELY.**

Thank you for your continued support, and welcome to the #FranklinFamily!

### 1 OR 2 PLAYER GAME OPTIONS:

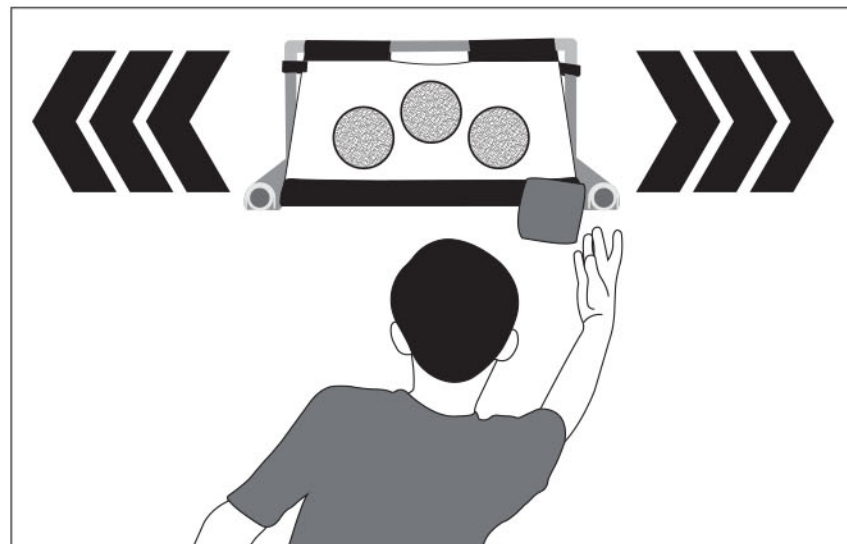

#### 1 PLAYER:

Play by yourself and see how many shots it takes you to get to 21! The next time you play, try to beat your last score!

# ASSEMBLY INSTRUCTIONS

STEP 6

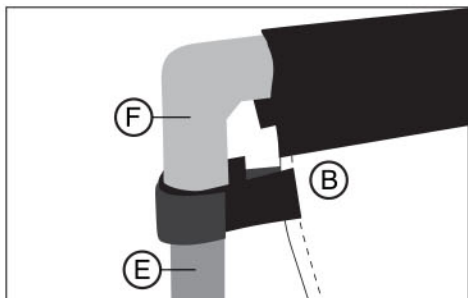
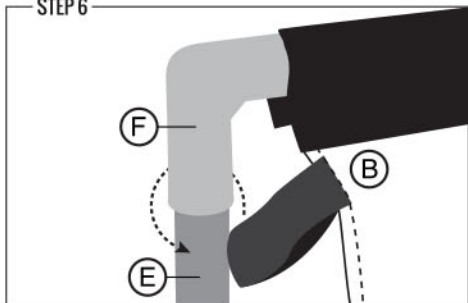

PARTS



NOTE

Wrap each self-stick side piece around part E of the frame to keep the target pulled tight during play.

You are now ready to play!

# PARTS LIST

<p><b>A</b></p> <p>QTY <b>x2</b></p>	<p><b>B</b></p> <p>QTY <b>x1</b></p>	<p><b>C</b></p> <p>QTY <b>x1</b></p>
<p>Long Tubes                      Target                      Left Side Base</p>		
<p>Rep. Part: 60273-R1                      Rep. Part: 60273-R2                      Rep. Part: 60273-R3</p>		
<p><b>D</b></p> <p>QTY <b>x1</b></p>	<p><b>E</b></p> <p>QTY <b>x2</b></p>	<p><b>F</b></p> <p>QTY <b>x2</b></p>
<p>Right Side Base                      Short Tubes                      Elbow Connectors</p>		
<p>Rep. Part: 60273-R4                      Rep. Part: 60273-R5                      Rep. Part: 60273-R6</p>		
<p><b>G</b></p> <p>QTY <b>x3</b></p>		<p><b>H</b></p> <p>QTY <b>x3</b></p>
<p>Green Bean Bags</p>		<p>Blue Bean Bags</p>
<p>Rep. Part: 60273-R7</p>		<p>Rep. Part: 60273-R8</p>

# ASSEMBLY INSTRUCTIONS

## GENERAL NOTES

- Remove all components from packaging.
- Sort all components using the parts list.

### STEP 1

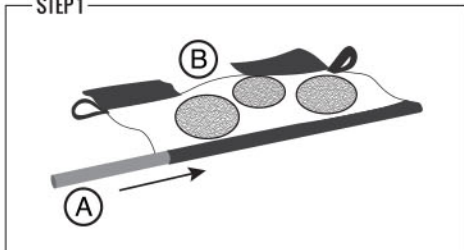

#### PARTS

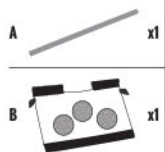

#### NOTE

Insert part **A** into the long bottom sleeve of part **B**.

### STEP 2

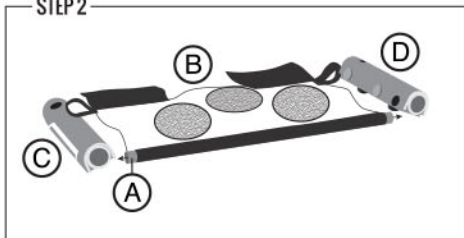

#### PARTS

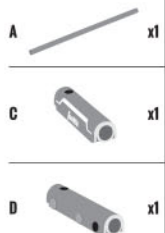

#### NOTE

Insert the left end of part **A** into the insert hole of part **C** as shown.

Insert the right end of part **A** into the insert hole of part **D** as shown.

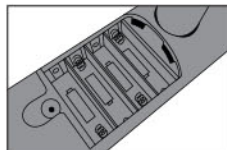
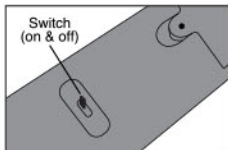
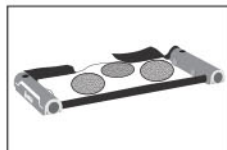
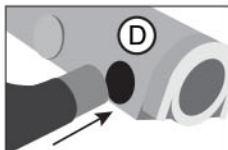

#### NOTE

Insert batteries into part **D**.

Requires 4 "AA" size batteries (not included). Do not mix old and new batteries. Do not mix alkaline, standard (carbon-zinc), or rechargeable batteries.

# ASSEMBLY INSTRUCTIONS

### STEP 3

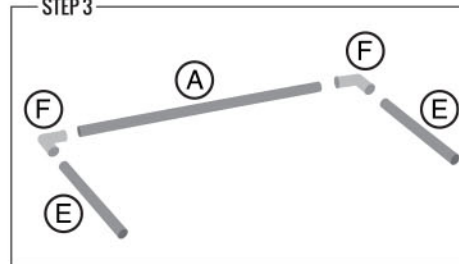

#### PARTS

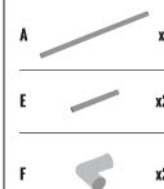

#### NOTE

Assemble the frame for the target as shown.

### STEP 4

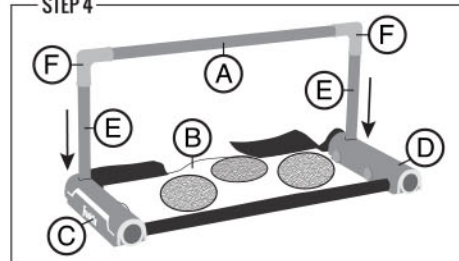

#### PARTS

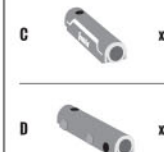

#### NOTE

Insert the frame into the insert holes of part **C** and part **D** as shown.

### STEP 5

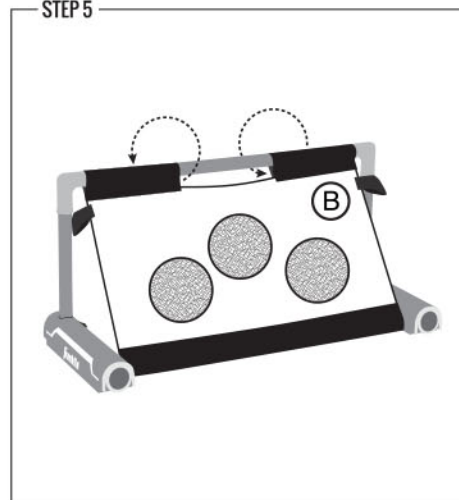

#### PARTS



#### NOTE

Lift the target and wrap each self-stick sleeve around the top shelf tubing as shown. Make sure that the self-stick sleeve is snug, without pulling the frame forward too much. Adjust the frame and ensure that all 4 wheels under the base touch the floor fully. When finished, the frame should be at a 90 degree angle from the moving bases. If the frame is leaning forward at all, the self-stick sleeves have been applied too tightly.