

STEP 3

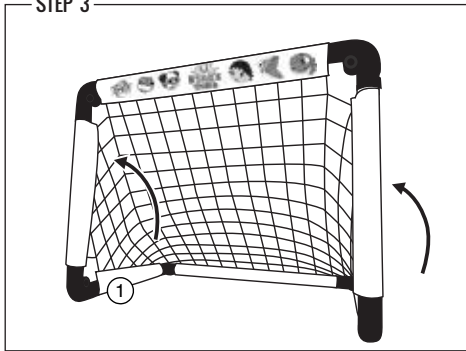

PARTS



NOTE

Unfold the top of the goal upward and snap to lock in place.

STEP 4

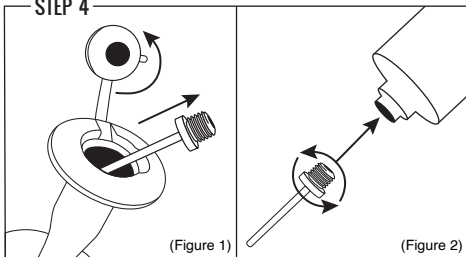

PARTS



NOTE

Inflate your Soccer Ball (2) using the Inflation Pump with Needle (3) that's included.

To find the needle in the pump, simply open the top cap as shown, take the needle out of this compartment (Figure 1), and screw into the bottom of the pump (Figure 2).

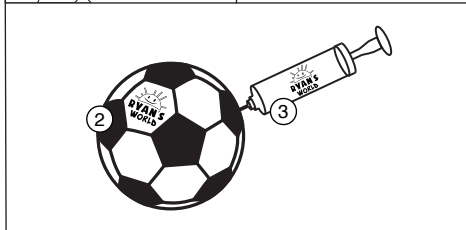

YOU ARE NOW READY TO PLAY!

STORAGE

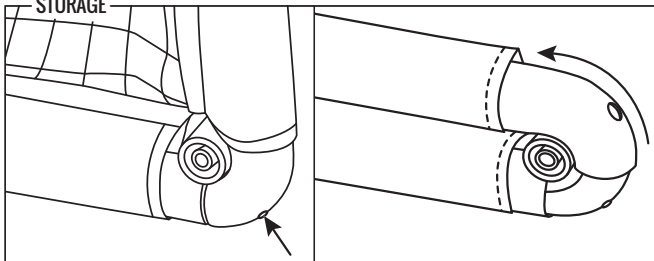

NOTE

Please be sure to push in tabs on both corners prior to folding each joint. Failure to do so may result in breakage. To fold INSTA-SET® goal, reverse steps 1-3.

Made in Thailand
Franklin Sports Inc.
Stoughton, MA 02072
TM & © REMKA



For replacement parts:
Visit: franklinsports.com/instructions
Email: parts@franklinsports.com
Call: 1-800-225-8649

Ages
3+

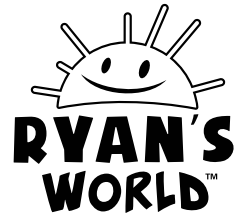

RYAN'S 24IN SOCCER GOAL WITH BALL & PUMP

ITEM NUMBER: **89165**



⚠ WARNING:
CHOKING HAZARD -- Small parts.
Not for children under 3 yrs.

NOTE: PRINT FRONT TO BACK

Franklin®

CUSTOMER SERVICE COMMITMENT

Thank you for purchasing this product! In the event that the product you've purchased has missing or damaged parts, please contact us at:

parts@franklinsports.com

or

Visit our website at: **franklinsports.com/instructions**

If possible, please include product part number and parts description so we can best assist you.



WE'RE HERE FOR YOU!

PLEASE DO NOT RETURN THIS PRODUCT TO THE STORE IT WAS PURCHASED FROM.

WE ARE COMMITTED TO FULFILLING ALL REPLACEMENT PART NEEDS IMMEDIATELY.

Thank you for your continued support, and welcome to the #FranklinFamily!

PARTS LIST

<p>1</p>  <p>Soccer Goal</p> <p>QTY x1</p>	<p>2</p>  <p>Soccer Ball</p> <p>QTY x1</p>	<p>3</p>  <p>Inflation Pump with Needle</p> <p>QTY x1</p>
---	---	--

ASSEMBLY INSTRUCTIONS

STEP 1

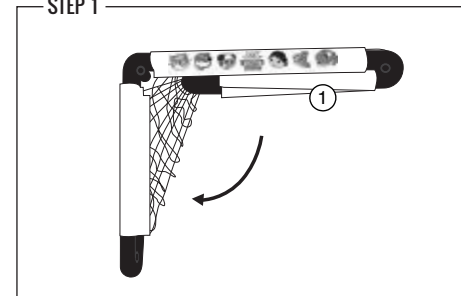

PARTS

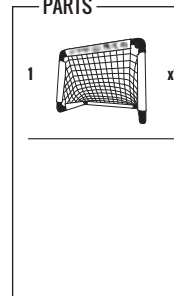

NOTE

Unfold as shown and snap to lock in place.

STEP 2

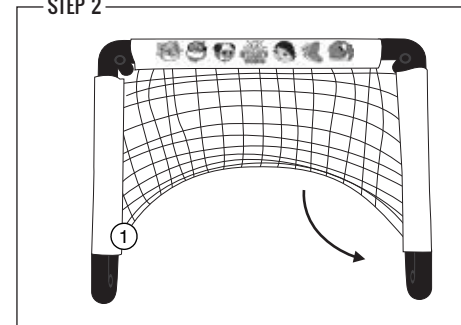

PARTS

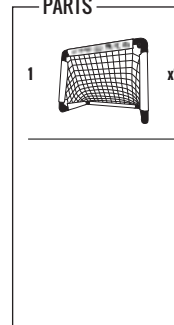

NOTE

Unfold as shown and snap to lock in place.